

GARDEN CITY ELEMENTARY SCHOOL RE-ROOFING PROJECT

GARDEN CITY, GEORGIA 31408

FOR

SAVANNAH CHATHAM COUNTY PUBLIC SCHOOL SYSTEM

BOARD OF EDUCATION

BID C17-21 ESLOST II

100% CONSTRUCTION DRAWINGS

ARCHITECTS:

COGDELL & MENDRALA ARCHITECTS, PC

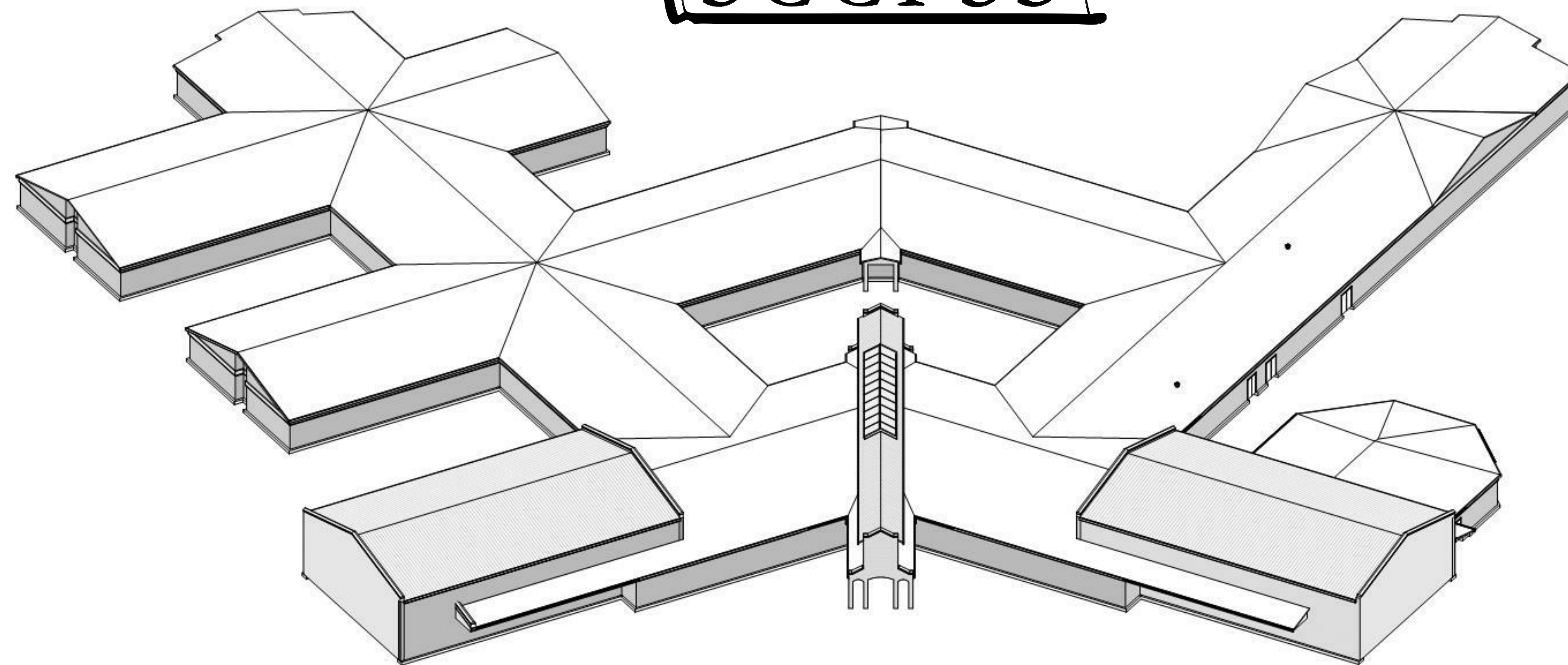

SCHEDULE OF DRAWINGS:

LIST OF DRAWINGS - ARCHITECTURAL

- | | |
|-------|-----------------------------------|
| A2.01 | ROOF PLAN |
| A8.31 | ROOF DETAILS |
| A8.32 | DETAILS AND WIND PRESSURE DIAGRAM |

LOCATION MAP:



SET NO. _____

SHEET:

T1.0



**GARDEN CITY ELEMENTARY
RE-ROOFING PROJECT**
4037 KESSLER AVENUE
GARDEN CITY, GEORGIA 31408

100% CONSTRUCTION DRAWINGS

Cogdell Mendrala Architects
COGDELL & MENDRALA ARCHITECTS, PC
517 EAST CONGRESS STREET
SAVANNAH, GEORGIA 31401
tel 912.234.6318
fax 912.236.8414
cogdellmendrala.com

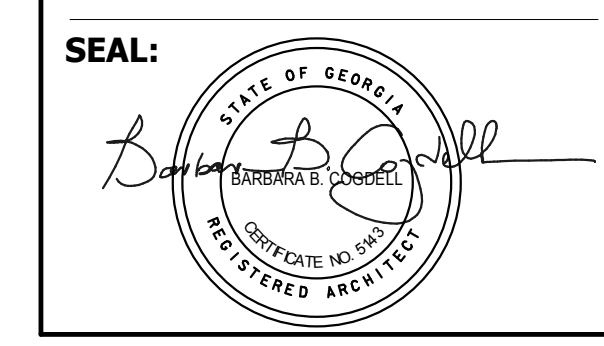

ROOF PLAN LEGEND

- AT LIGHTNING PROTECTION AIR TERMINAL LOCATION, ROOF MOUNTED
- ATW LIGHTNING PROTECTION AIR TERMINAL LOCATION, WALL MOUNTED
- DS DOWNSPOUT
- SB SPLASH BLOCK, PRECAST CONCRETE
- VTR PLUMBING VENT (EXISTING TO REMAIN)
- DS DOWNSPOUT
- ROOF CURB (EXISTING TO REMAIN)

ROOF PLAN NUMBERED NOTES

- 1 REMOVE EXISTING GUTTER. PROVIDE GUTTER AND DOWNSPOUTS AS INDICATED.
- 2 PROVIDE GUTTER AND DOWNSPOUTS AS INDICATED.
- 3 REMOVE SEALANT FROM EXISTING WEEP HOLES IN MASONRY
- 4 REMOVE EXISTING MAST AND CABLE TELEVISION CABLES. PATCH DECK AS REQUIRED.
- 5 PROVIDE BOOT AT LIGHTNING PROTECTION CABLE PENETRATION
- 6 REMOVE EXISTING SKYLIGHT. PREPARE OPENING FOR SKYLIGHT TO BE INSTALLED UNDER THIS CONTRACT.

GENERAL ROOF PLAN NOTES

- 1 NOT ALL PENETRATIONS ARE SHOWN ON ROOF PLAN. SEE MECHANICAL & PLUMBING DRAWINGS FOR ACTUAL ROOF PENETRATION QUANTITIES. NOTIFY ARCHITECT OF ANY PENETRATIONS NOT SHOWN ON ROOF PLAN TO COORDINATE FINAL LOCATIONS.
- 2 INSTALL ALL SHEET METAL FLASHINGS IN ACCORDANCE WITH SMACNA SHEET METAL MANUAL, CURRENT EDITION.
- 3 INSTALL BOOTS AT ALL VENT PENETRATIONS IN ROOF.
- 4 DOWNSPOUT SIZE AND CONFIGURATION TO MATCH EXISTING DOWNSPOUTS.
- 5 WHERE A NOTED DETAIL IS SHOWN FOR ONE CONDITION IT SHALL APPLY TO ALL SIMILAR AND LIKE CONDITIONS, UNLESS NOTED OTHERWISE.
- 6 INSTALL FLASHING AT ALL ROOF PENETRATIONS.
- 7 GUTTERS SHALL BE SLOPED TOWARDS DOWNSPOUTS.
- 8 AT AREAS OF EXPOSED METAL DECK IN OCCUPIED AREAS (ART 405, MAIN ENTRANCE 100, MEDIA CENTER 201, LOBBY 200, GYM 127, AND EXTERIOR PORCHES, DO NOT ALLOW FASTENERS TO PENETRATE ACOUSTICAL LINER PANELS. DECK IS SHOWN AS 1 1/2" THICK IN ORIGINAL CONSTRUCTION DOCUMENTS.
- 9 PROVIDE NICKEL PLATED COPPER LIGHTNING PROTECTION AIR TERMINALS AT ALL LOCATIONS WITH MISSING OR BROKEN AIR TERMINALS UNDER "UNIT COST". AT DAMAGED AIR TERMINAL BASES, PROVIDE BASE UNDER "UNIT COST".
- 10 ROOFING CONTRACTOR SHALL ENGAGE THE SERVICES OF A CERTIFIED LIGHTNING PROTECTION SYSTEM INSTALLER TO INSPECT AND MAKE NECESSARY REPAIRS AND MODIFICATIONS TO THE EXISTING SYSTEM TO ENSURE THAT IT IS IN COMPLIANCE WITH CURRENT EDITION OF NFPA 780 AND TO ACHIEVE A NEW UL MASTER LABEL. IT IS THE CONTRACTOR'S RESPONSIBILITY TO HAVE THE FINAL SYSTEM CERTIFIED BY UL.
- 11 THE BONDING OF COPPER AND ALUMINUM CONDUCTORS SHALL BE DONE WITH BIMETAL CONNECTORS LISTED UNDER UL96. PROVIDE SHOP DRAWINGS OF MATERIALS AND PROCESS PRIOR TO WORK BEING DONE.
- 12 RELOCATE EXISTING PLUMBING VENT PENETRATIONS MINIMUM 2" FROM APPLIED RIBS.

KEY PLAN:

**SHEET TITLE:
ROOF PLAN**

REVISION SCHEDULE	
DATE	DESCRIPTION

PROJECT: BID C17-21 ESPLOST II
DATE: PROJECT ISSUE DATE
DRAWN BY: Author
SCALE: 1" = 20'-0"
FTE: 1150

SHEET: **A2.01**

C:\Users\nudd\Documents\1607 GARDEN CITY REROOF central_nudd.rvt

2/24/2017 10:06:24 AM

1 ROOF PLAN
A2.01 1" = 20'-0"

C:\Users\nudd\Documents\1807 GARDEN CITY REROOF central_nudd.rvt 2/24/2017 10:06:26 AM

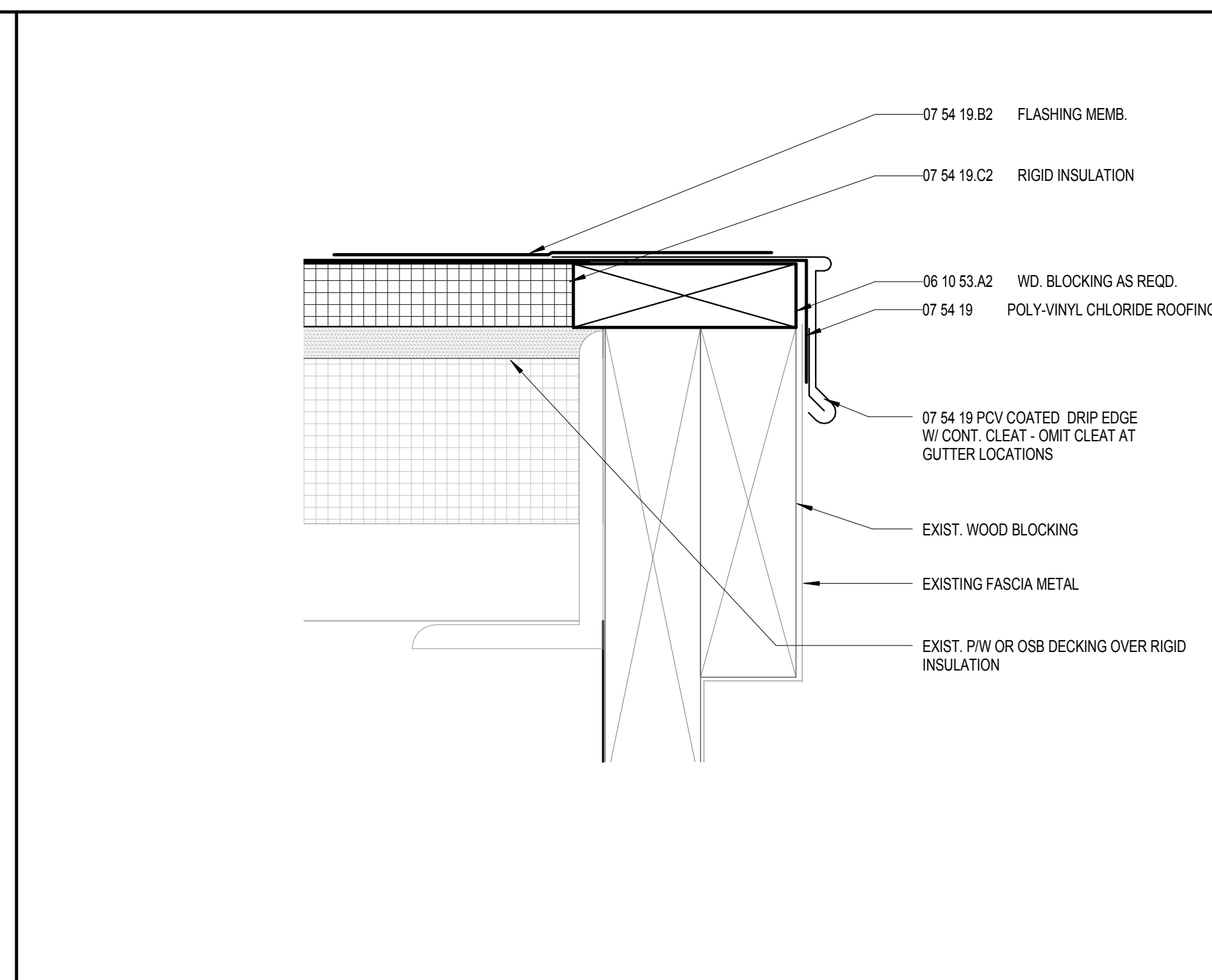
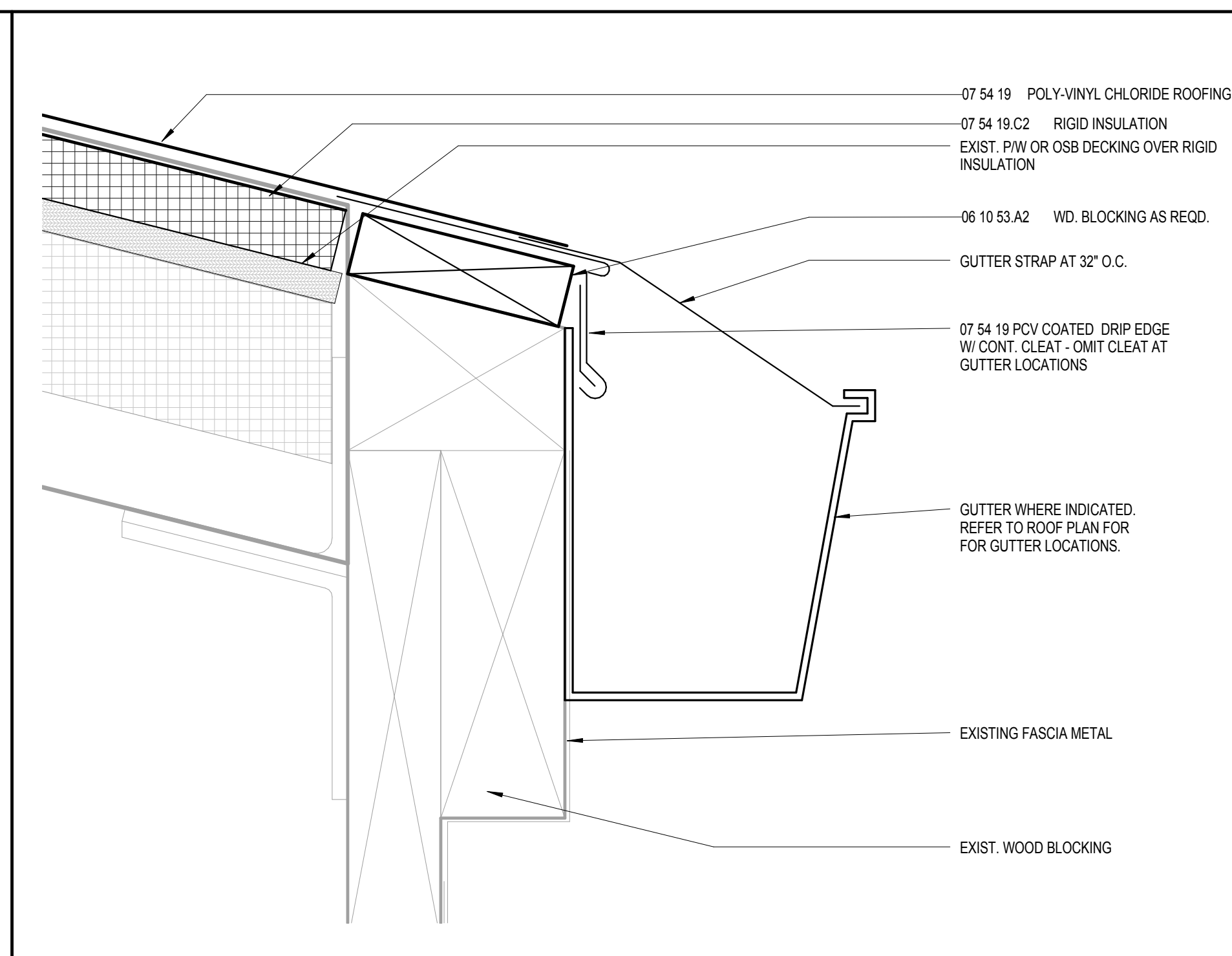
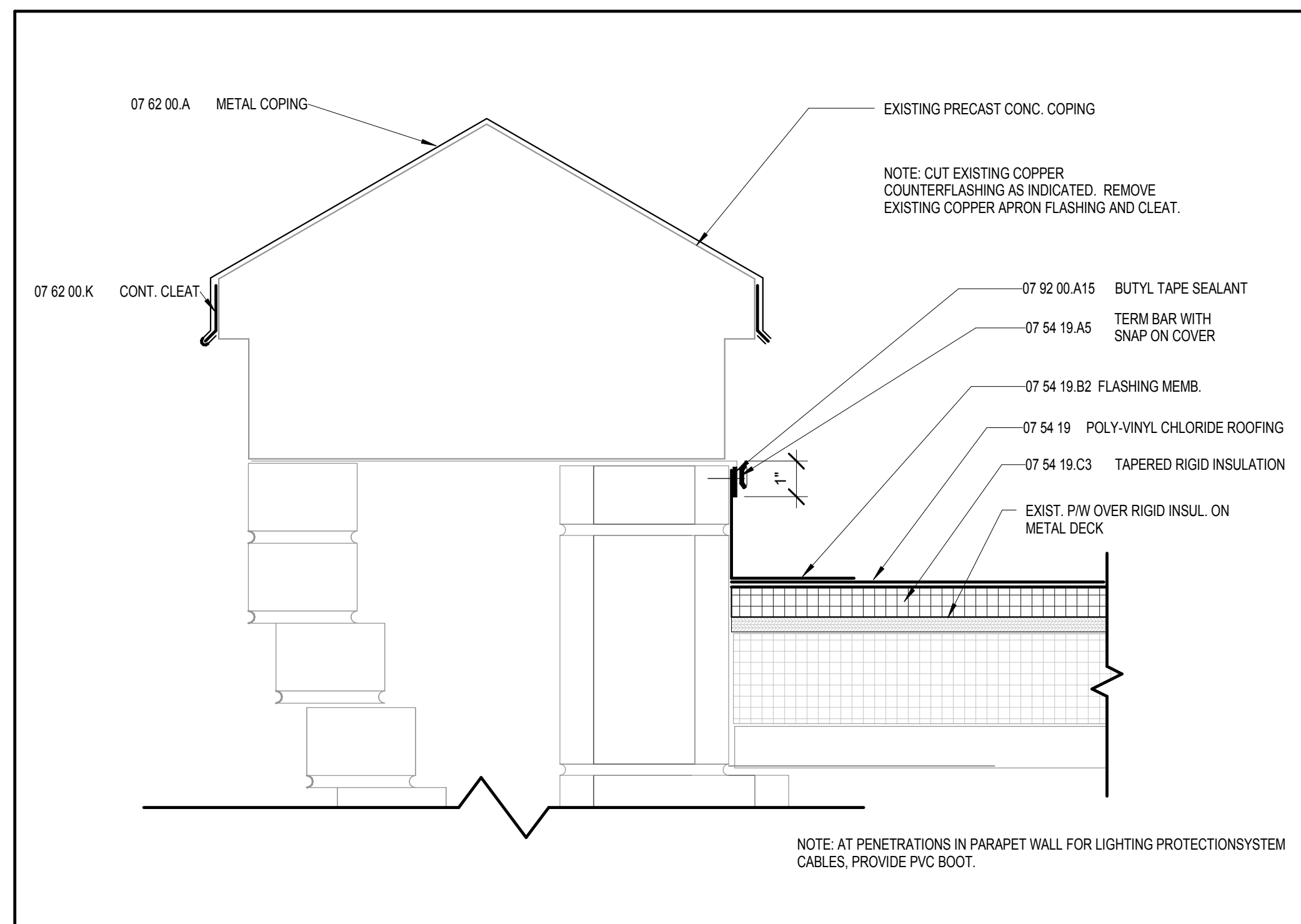

KEYNOTE LEGEND - BY SHEET

Key Value	Keynote Text
06 10 53.A2	WD. BLOCKING AS REQD.
06 10 53.C1	2X NAILER
07 54 19	POLY-VINYL CHLORIDE ROOFING
07 54 19.A5	TERM BAR WITH SNAP ON COVER
07 54 19.B2	FLASHING MEMB.
07 54 19.C2	RIGID INSULATION
07 54 19.C3	TAPERED RIGID INSULATION
07 62 00.A	METAL COPING
07 62 00.K	CONT. CLEAT
07 92 00.A14	BUTYL JOINT SEALANT
07 92 00.A15	BUTYL TAPE SEALANT
08 45 23	FIBERGLASS-SANDWICH-PANEL ASSEMBLIES

1 PARAPET DETAIL GYM
A8.31 3" = 1'-0"

2 EAVE - TYPICAL
A8.31 6" = 1'-0"

3 RAKE DETAIL
A8.31 6" = 1'-0"

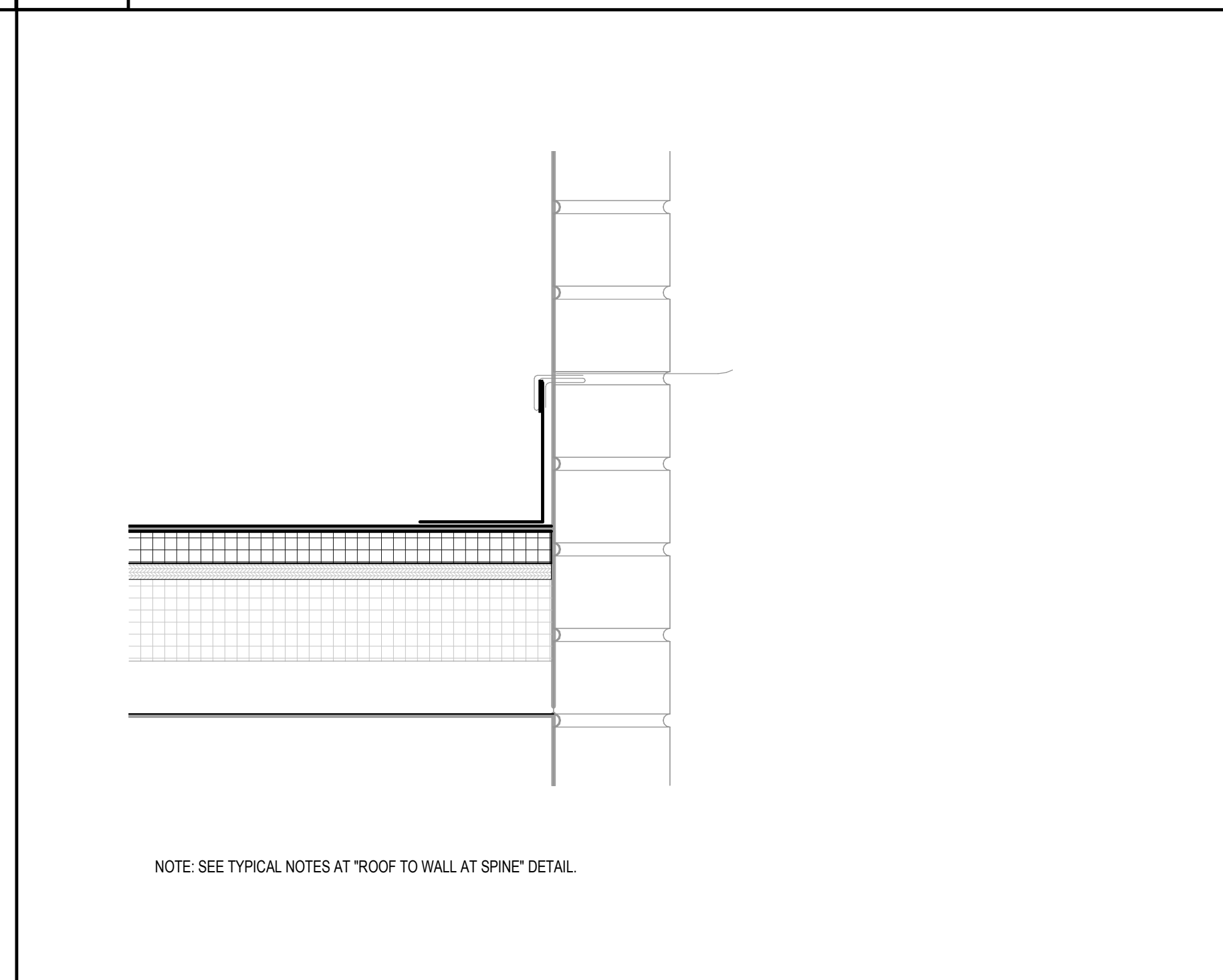
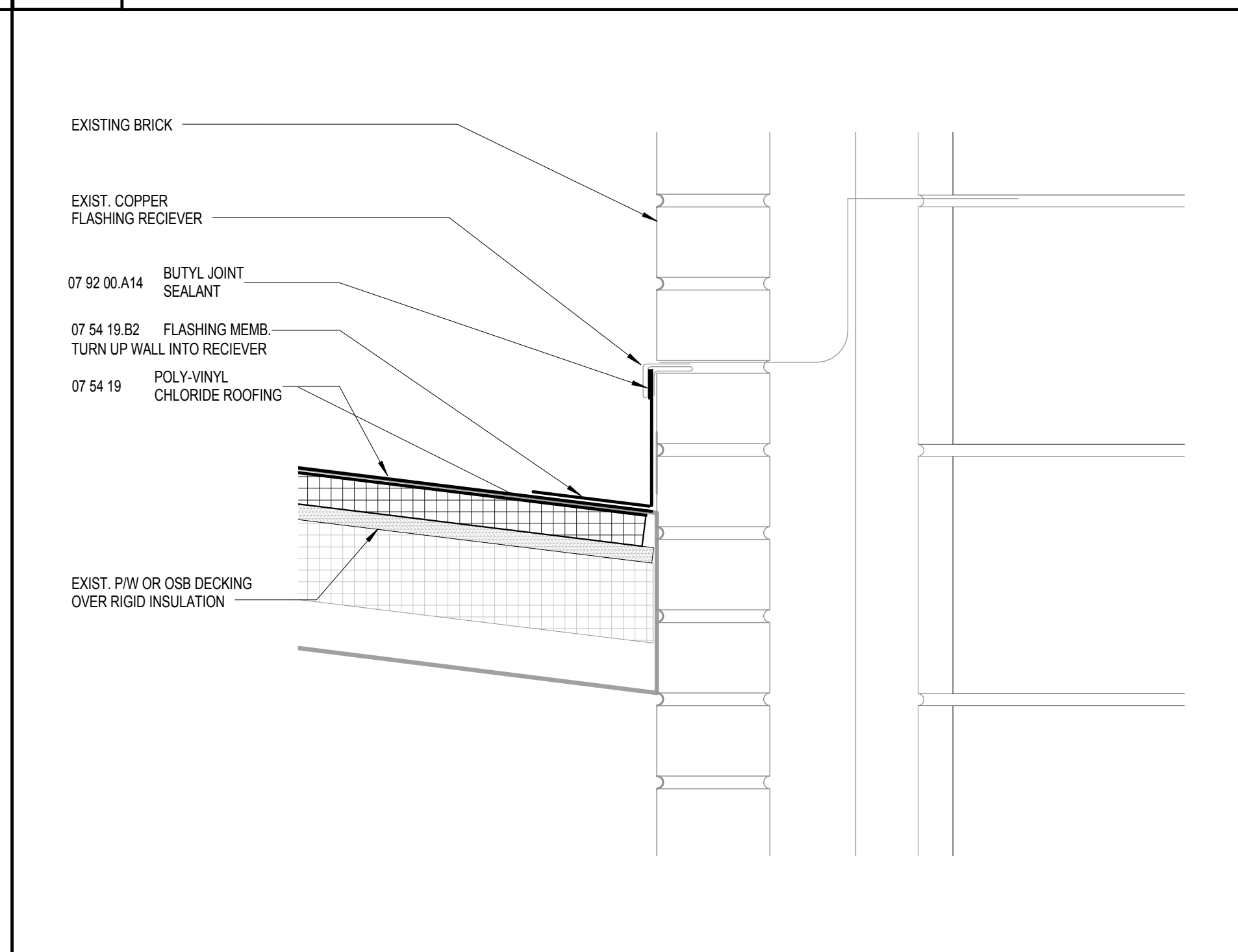
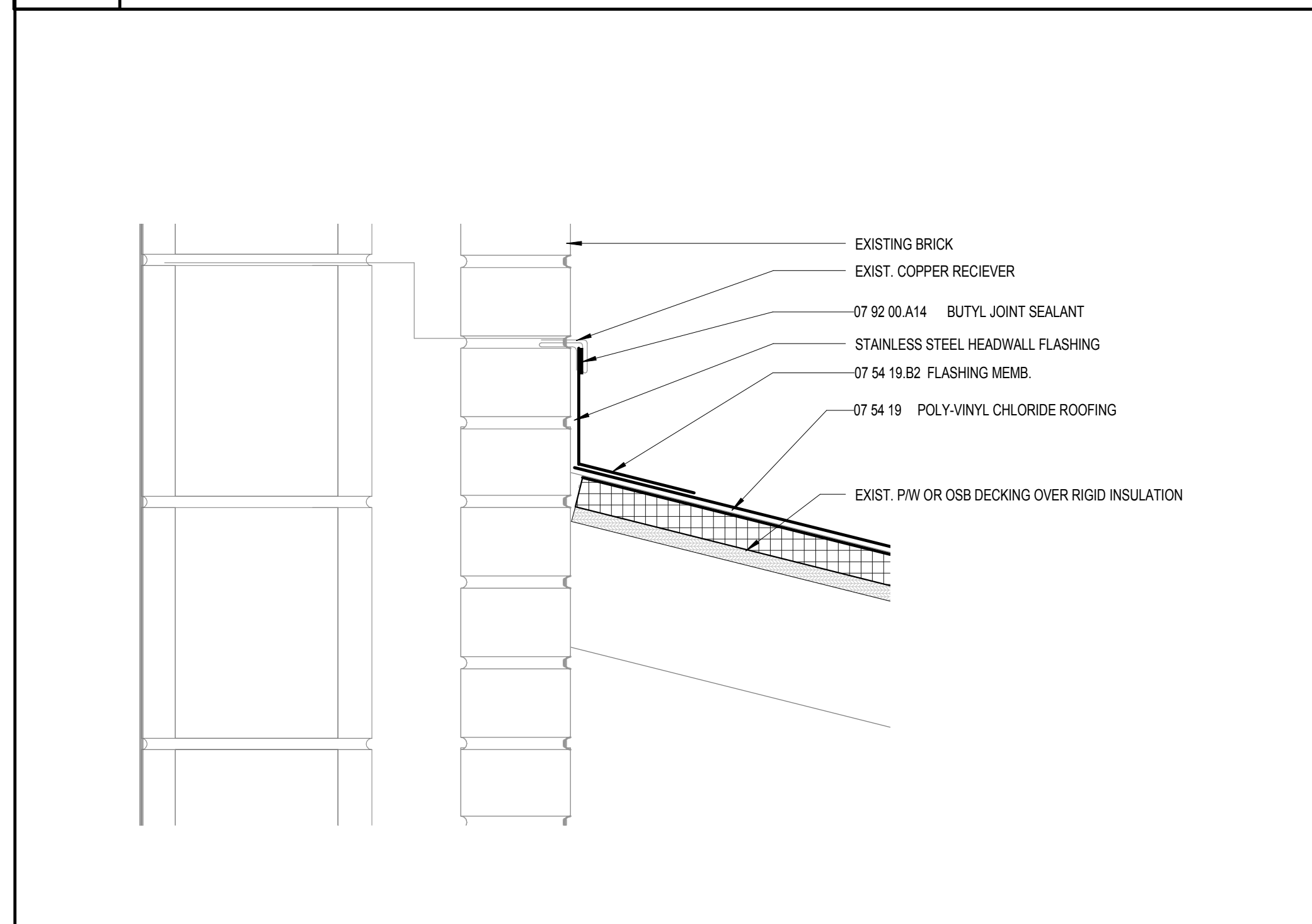

4 LOW ROOF HEADWALL - SHINGLE
A8.31 3" = 1'-0"

5 ROOF TO WALL AT SPINE
A8.31 3" = 1'-0"

6 RAKE WALL
A8.31 3" = 1'-0"

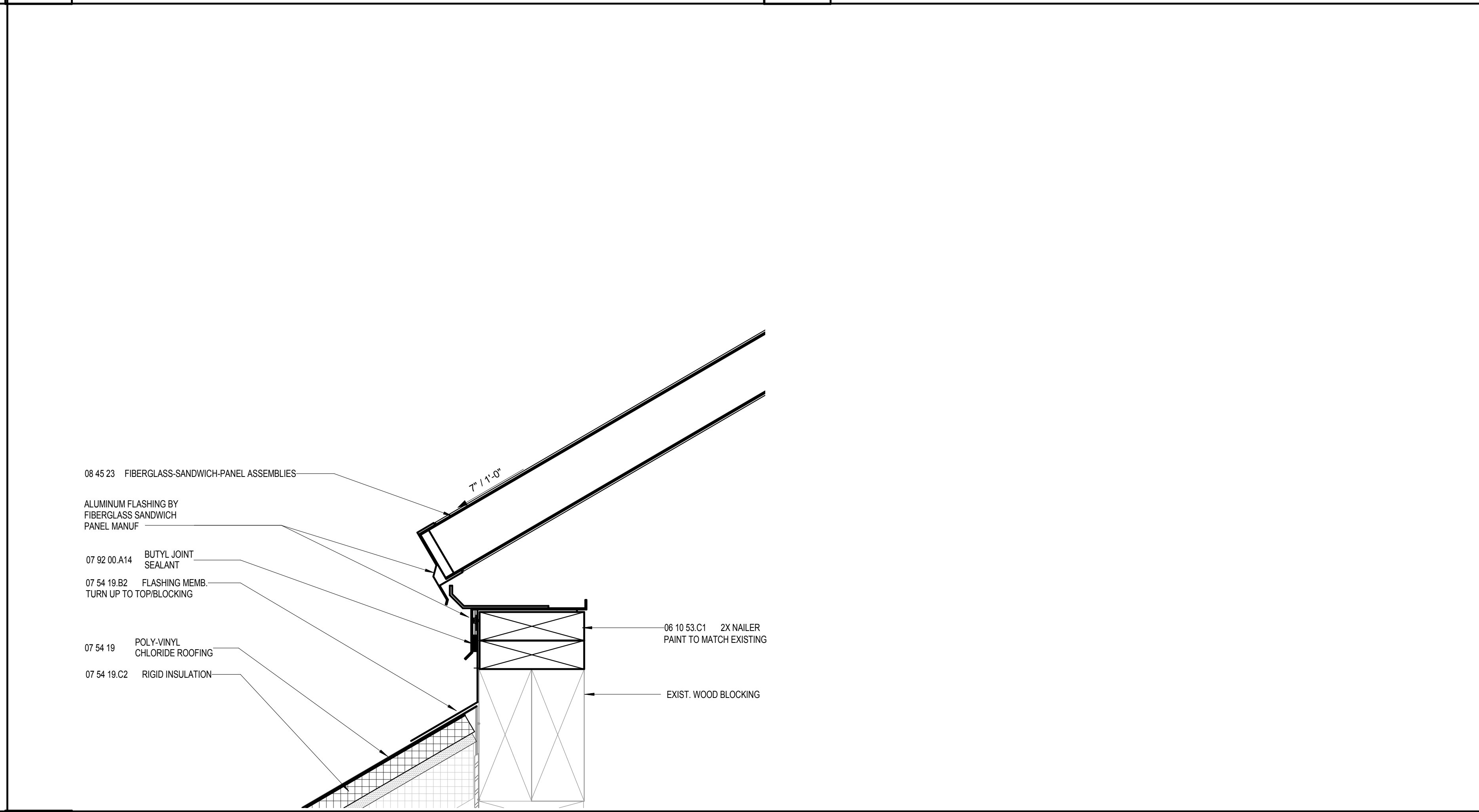
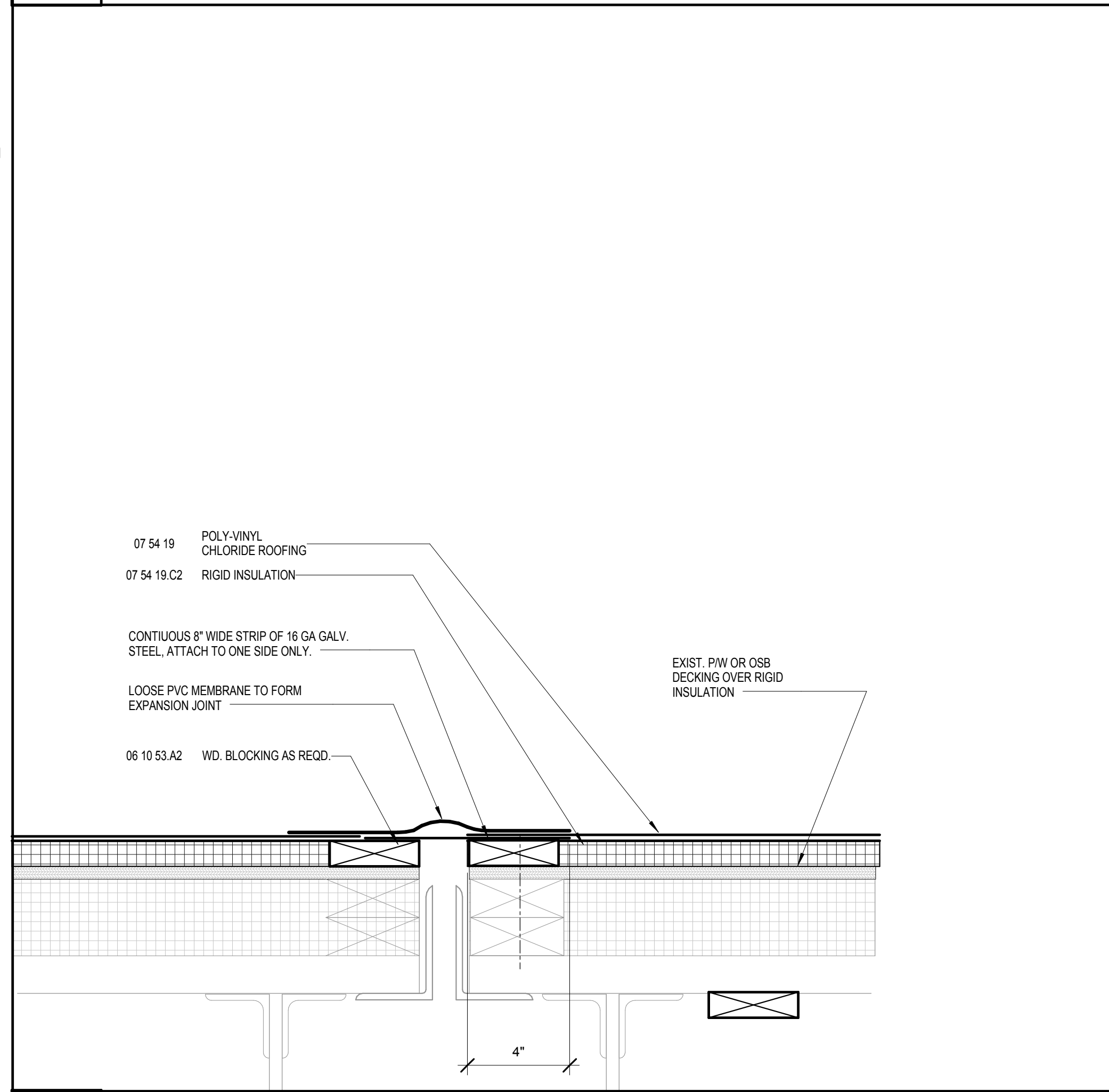

7 EXPANSION JOINT DETAIL
A8.31 3" = 1'-0"

8 SKYLIGHT EAVE
A8.31 3" = 1'-0"

GARDEN CITY ELEMENTARY RE-ROOFING PROJECT
4037 KESSLER AVENUE
GARDEN CITY, GEORGIA 31408
100% CONSTRUCTION DRAWINGS

Cogdell Mendrala Architects
COGDELL & MENDRALA ARCHITECTS, PC
517 EAST CONGRESS STREET
SAVANNAH, GEORGIA 31401
tel 912.234.6318
fax 912.236.8414
cogdellmendrala.com

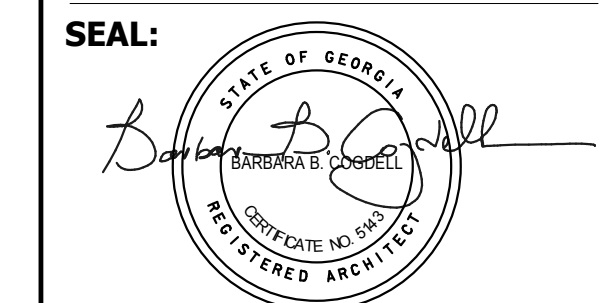

KEY PLAN:

SHEET TITLE:
ROOF DETAILS

REVISION SCHEDULE

DATE	DESCRIPTION

PROJECT: BID C17-21 ESPLOST II
DATE: PROJECT ISSUE DATE
DRAWN BY: Author
SCALE: As indicated
FTE: 1150

SHEET: **A8.31**

KEYNOTE LEGEND - BY SHEET	
Key Value	Keynote Text
07 54 19	POLY-VINYL CHLORIDE ROOFING
07 54 19.C2	RIGID INSULATION



SCCPSS

**GARDEN CITY ELEMENTARY
RE-ROOFING PROJECT**
4037 KESSLER AVENUE
GARDEN CITY, GEORGIA 31408
100% CONSTRUCTION DRAWINGS

Cogdell Mendrala Architects
COGDELL & MENDRALA ARCHITECTS, PC
517 EAST CONGRESS STREET
SAVANNAH, GEORGIA 31401
tel 912.234.6318
fax 912.236.8414
cogdellmendrala.com

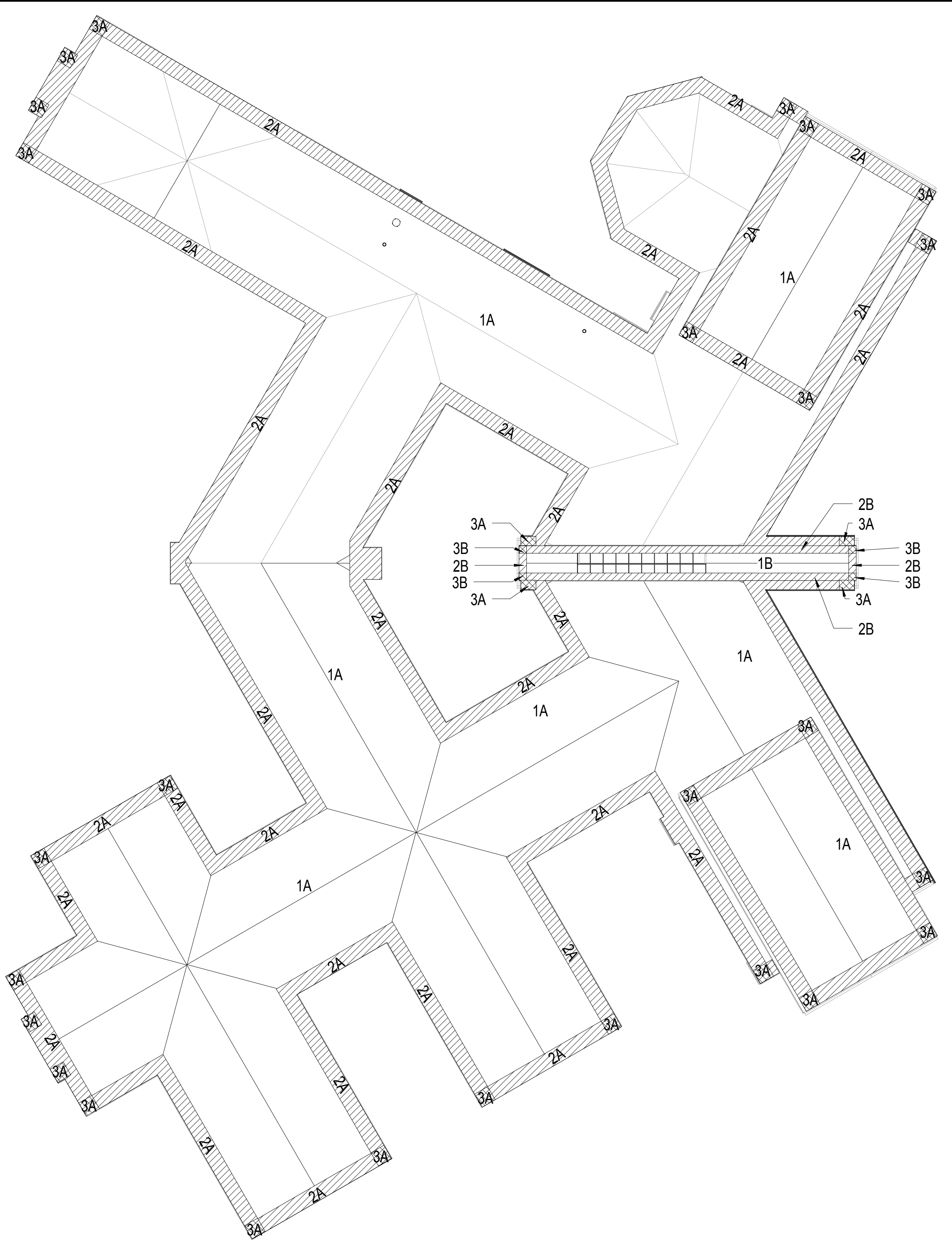
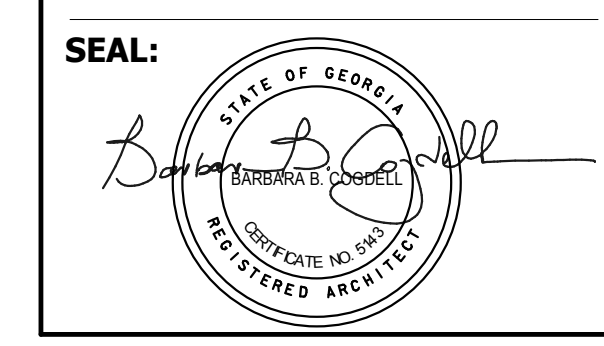

AREA	PRESSURE (PSF)
1A	-44
1B	-47
2A	-77
2B	-57
3A	-115
3B	-57

WIND PRESSURES VALUES

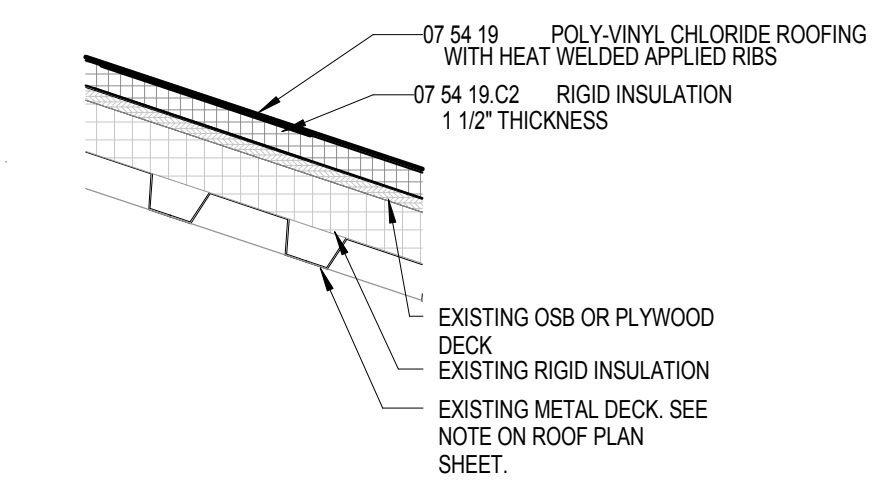

ROOF TYPE R1

1	WIND PRESSURE DIAGRAM
A8.32	1" = 30'-0"

NOTES:

AT EXISTING LIGHTNING PROTECTION AIR TERMINALS MISSING VERTICAL ROD, PROVIDE VERTICAL ROD UNDER 01 22 00 "UNIT PRICES"
AT EXISTING LIGHTNING PROTECTION AIR TERMINALS MISSING VERTICAL ROD AND BASE, OR WITH DAMAGED BASE, PROVIDE VERTICAL ROD AND BASE UNDER 01 22 00 "UNIT PRICES"

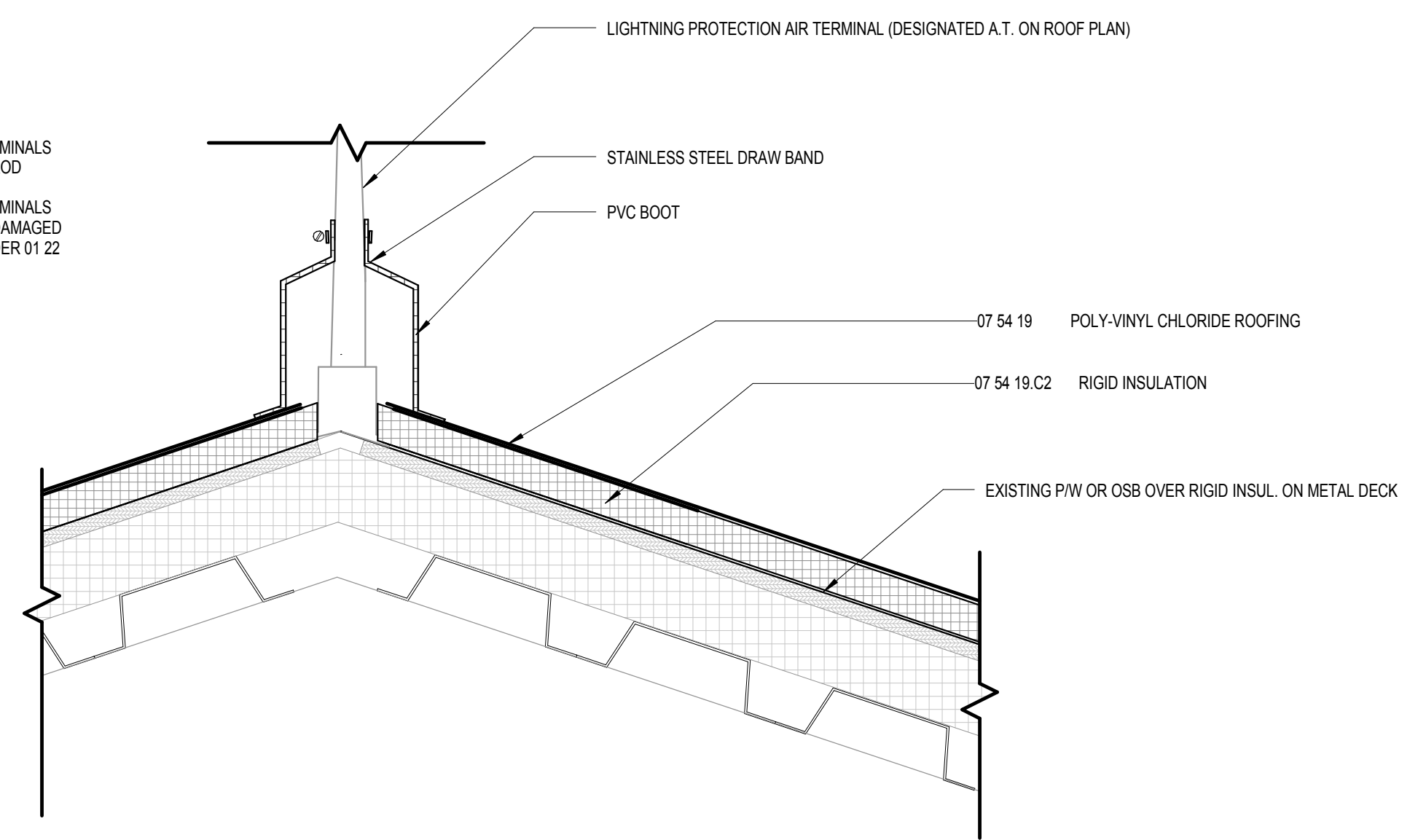

2	RIDGE DETAIL AT AIR TERMINAL
A8.32	3" = 1'-0"

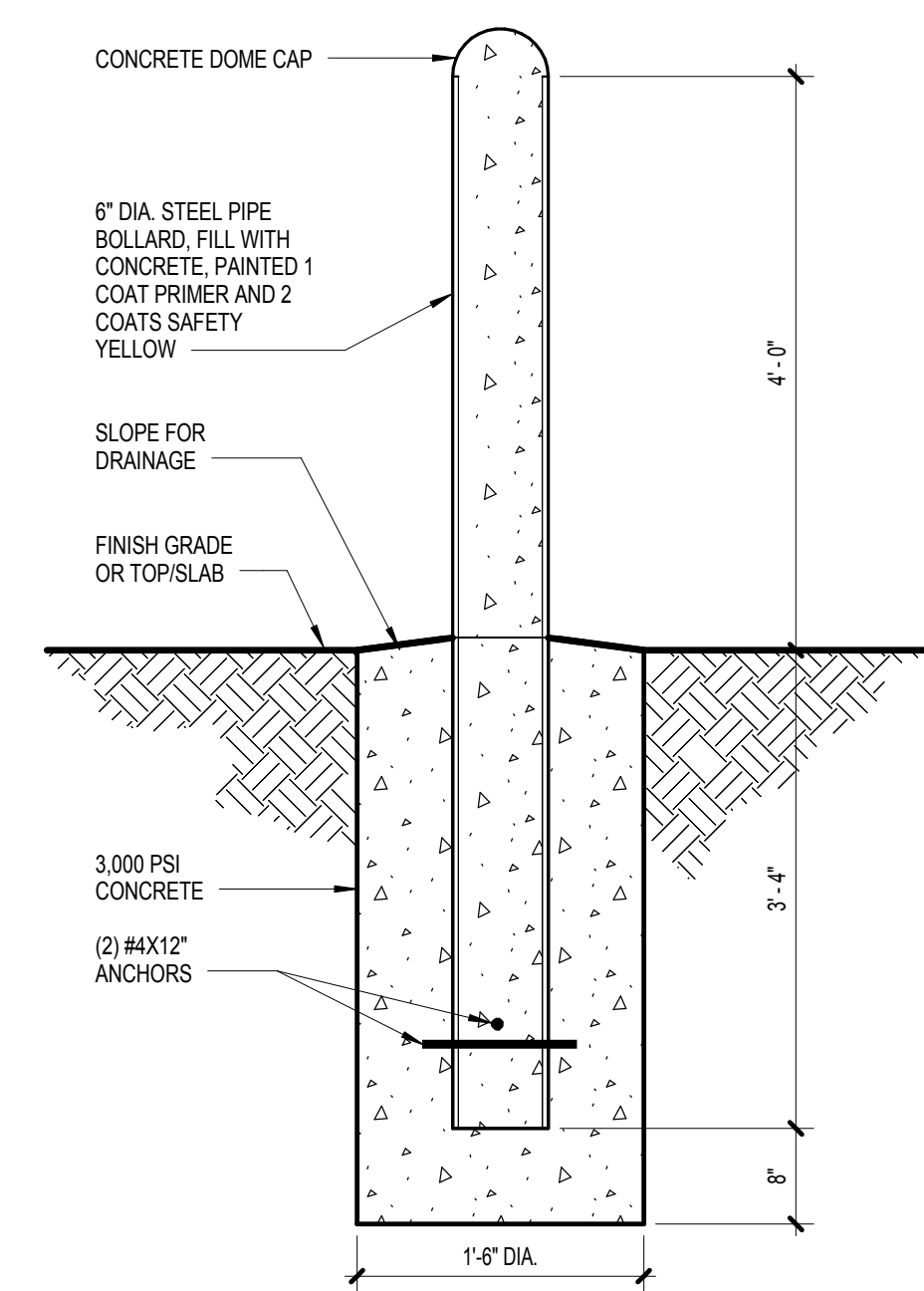

3	BOLLARD DETAIL
A8.32	3/4" = 1'-0"

KEY PLAN:

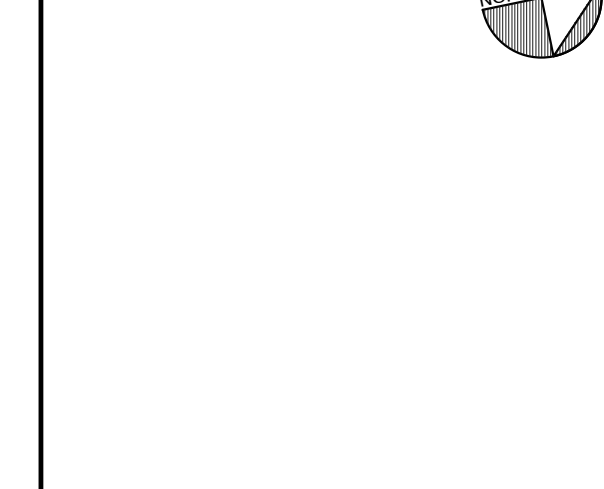

SHEET TITLE:
DETAILS AND WIND PRESSURE DIAGRAM

REVISION SCHEDULE	
DATE	DESCRIPTION

PROJECT: BID C17-21 ESPLOST II
DATE: PROJECT ISSUE DATE
DRAWN BY: Author
SCALE: As indicated
FTE: 1150

SHEET: **A8.32**

C:\Users\nudd\Documents\1607 GARDEN CITY REROOF central_nudd.rvt 2/24/2017 10:06:27 AM